

## RACCORDS INSTANTANÉS POLYMÈRES

Banjo femelle cylindrique orientable  
- RPB FG

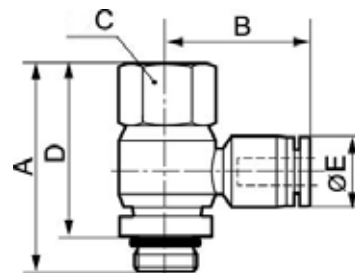

Pression d'utilisation min/max

0 / 10 bar

Température min/max

0 / 60 °C

Référence	Taraudage	Cote A (mm)	Cote B (mm)	Cote C (mm)	Cote D (mm)	Cote E (mm)
RPB FG04M5	M5	20	19.7	8	16	10
RPB FG0400	G1/8	30	23.5	12	24.5	10
RPB FG0401	G1/4	32	24	17	26	10
RPB FG05M5	M5	20	22.3	10	16	12.8
RPB FG0500	G1/8	30	23.5	12	24.5	12.8
RPB FG0501	G1/4	32	25	17	26	12.8
RPB FG0502	G3/8	39	26.5	19	32.5	12.8
RPB FG0503	G1/2	42	29.5	24	34	12.8
RPB FG06M5	M5	20	22.3	8	16	12.8
RPB FG0600	G1/8	30	23	12	24.5	12.8
RPB FG0601	G1/4	32	25	17	26	12.8
RPB FG0602	G3/8	39	26.5	19	32.5	12.8
RPB FG0603	G1/2	42	29.8	24	34	12.8
RPB FG0800	G1/8	30	25	12	24.5	13.8
RPB FG0801	G1/4	32	27	17	26	13.8
RPB FG0802	G3/8	39	29	19	32.5	13.8
RPB FG0803	G1/2	42	30.3	24	34	13.8
RPB FG1000	G1/8	30	29	12	24.5	16.8
RPB FG1001	G1/4	32	33	17	26	16.8
RPB FG1002	G3/8	39	32	19	32.5	16.8
RPB FG1003	G1/2	42	34	24	34	16.8
RPB FG1201	G1/4	32	31	17	26	19.8
RPB FG1202	G3/8	39	34	19	32.5	19.8
RPB FG1203	G1/2	42	36	24	34	19.8
RPB FG1602	G3/8	39	34	19	32.5	23.8
RPB FG1603	G1/2	42	36.3	24	34	23.8